

CLUBHOUSE

A/C AREA: 6,410 SQ. FT.
TERRACE AREA = 720 SQ.FT.
TOTAL GROSS = 7,300 SQ.FT.

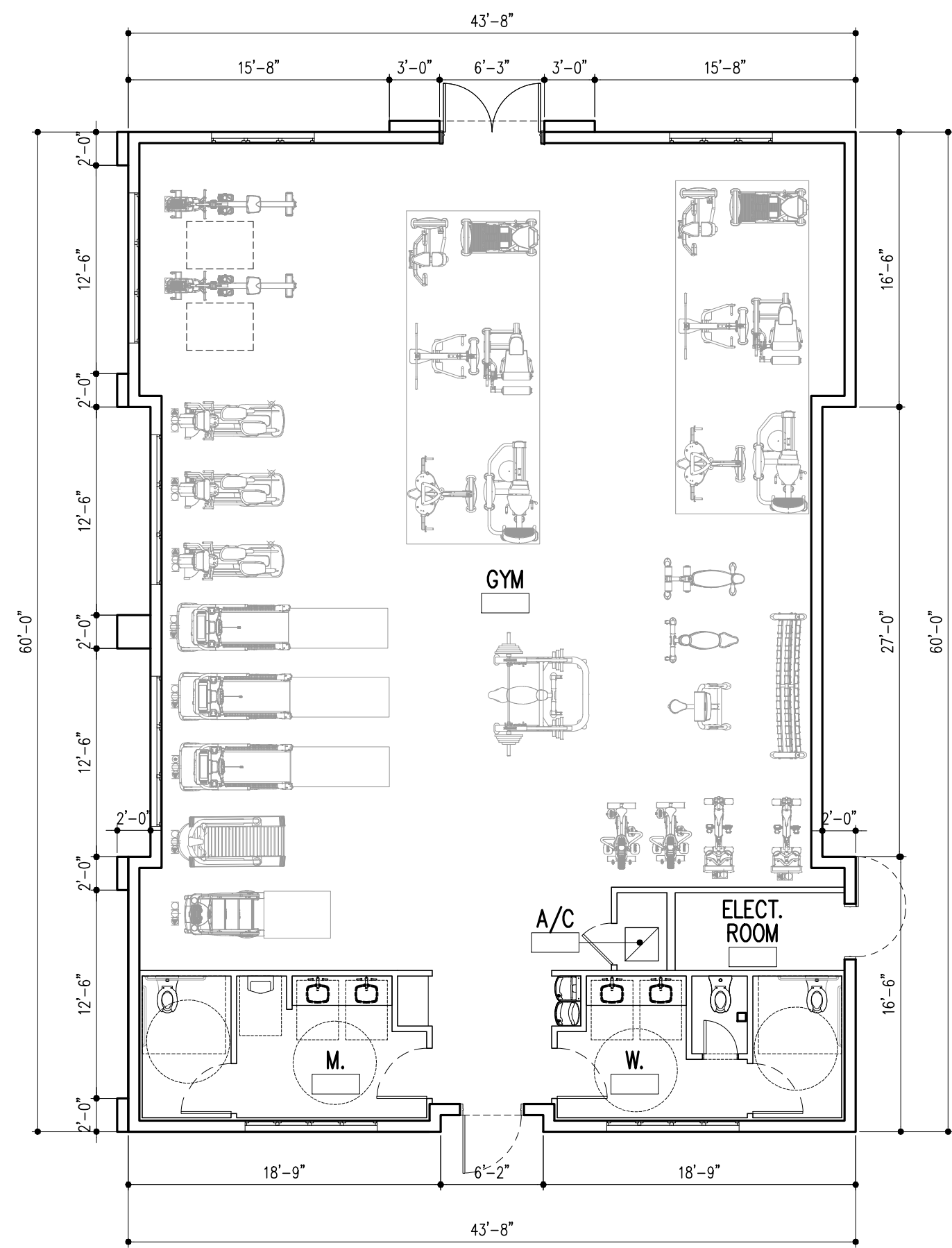

GYM

A/C AREA: 2,524 SQ. FT.

AAC

PZ23-12000017

03/05/2025



RESI CLUBHOUSE/GYM-FLOOR PLAN

SCALE: 1/8"=1'-0"

DRAWN
CONTRACT DATE 10/12/22
SCALE AS SHOWN
JOB NO. 2181.PRJ

SHEET TITLE:
RESI CLUBHOUSE
/GYM
FLOOR PLAN
SHEET NUMBER:
CH-2.1

MSA

ARCHITECTS

ARCHITECTURE & PLANNING

MSA ARCHITECTS, INC.
AAC000895
8950 SW 74th COURT
MIAMI, FLORIDA 33156
(305) 273-9911

FOR:
MORGUARD
LOCATED AT:
POMPANO BEACH, FLORIDA

JOSE I. SAUMELL
AR0013085

STATE OF FLORIDA
REGISTERED ARCHITECT
1
JOSAMUEL SAUMELL

OAKS @ PALM AIRE

PRE-APP MEETING 04/04/2023	BY
DRC SUBMITTAL 08/13/2023	
DRC RE-SUBMITTAL 08/16/2023	
DRC RE-SUBMITTAL 01/01/2024	
DRC RE-SUBMITTAL 10/16/2024	
DRC RE-SUBMITTAL 12/10/2024	
DRC RE-SUBMITTAL 01/29/2025	